



Canopy Light C0820-XX-FPC Series

project name	type
catalog number	
comments	voltage
approved by	date

80-120
watts

up to
105
lpw

4000K/
5000K
color temp

120-277/
347/480
AC Input
Voltage

features

- Designed to retrofit into existing LSI Scottsdale, Dakota, and Richmond Canopy fixtures
- Most efficient LED fixture on the market - as much as 105 lpw
- Patented individual LED heatsink provides unrivaled thermal control
- Superior optical control through a proprietary lensing process
- Unique modular design provides scalability
- >90% of initial light output after 60,000 hrs
- Available in 3 wattages: 80W, 100W, 120W
- Easy installation and maintenance
- Optimum gas canopy optic lens design
- Typically replaces 250W to 400W HID
- Surface mount enclosure accessory can be ordered separately

performance

- Choice of 4000K or 5000K color temperature
- Optimum canopy light distribution
- Exceptional vertical illumination at the pump
- CRI > 70
- Power Input: 120-277 VAC 50/60Hz
- Power Factor: ≥95%
- THD <20% at full load
- Power consumption: 80-120 W
- Optional 347, 480V transformer
- Operates in -40°C to 55°C ambient temperatures

applications

- Gas Station Canopies
- Bank Drive-Thru Canopies
- Loading Docks
- Mass Transit Depots

ordering information C0820-XX-FPC Series

Example: C0820 - RF - 80W - 50K - N39 - W - N - U

1. Model	2. Type	3. Wattage	4. CCT	5. Lens	6. Finish	7. Options	8. Voltage	Accessories	LED vs. Typical HID
C0820	*RF - Dakota™ Retrofit HC - Scottsdale™ Retrofit KC - Richmond™ Retrofit	✓80W - 8,000 Lumens ✓100W - 10,000 Lumens ✓120W - 12,000 Lumens	40K - 4000K 50K - 5000K	N39 - Type V (Wide)	W - White	N - None D - 0-10V Dimming 2L - Step Dimming	U - 120-277V 347V - 347V 480V - 480V	*SME - Surface Mount Enclosure	80W 250-320W 100W 320-400W 120W 400W

✓ DesignLights Consortium® Qualified

*Dakota retrofit with SME required for complete surface mount fixture



RoHS
Compliant

Canopy Light C0820-XX-FPC Series

photometrics

Isofootcandle plots based on C0820-120W-50K @ 12,600 lms. Distances are in units of mounting height (15').

LEGEND
■ 1 fc
■ 2 fc
■ 5 fc
■ 10 fc

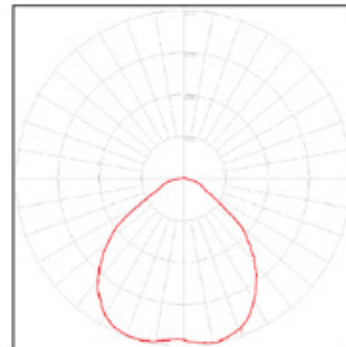
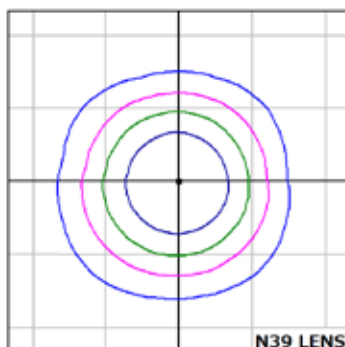

mounting options

HC Series
Slide-In Design

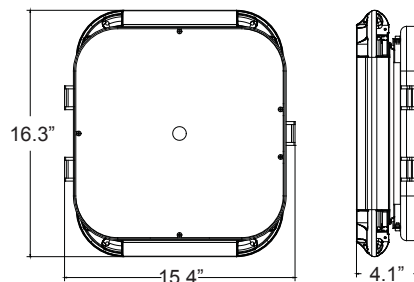

RF Series
Slim Design

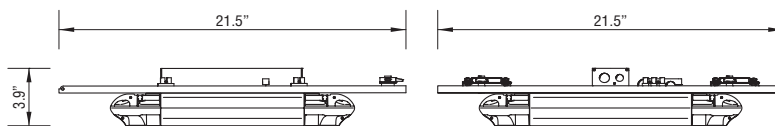

EiKO's new line of LED fixtures were designed and manufactured in a collaborative effort with SANSI to further differentiate LitespanLED® as one of the most comprehensive and efficient LED fixture offerings available to the industry today.

watch > like > follow



selection. solutions. simplicity. eiko.com

23220 W. 84th St, Shawnee, KS 66227 • (P) 1.800.852.2217 (F) 1.800.492.8975
Canada: 81 King St, Barrie, ON L4N 6B5 • (P) 1.888.410.8151 (F) 1.888.705.1335

RF Series - Slim Design				
Ordering Code	Watts	Volts	Lumens	Approvals
C0820-RF-100W-50K-N39-6WNU	100	120~277 VAC		ETL, LM79
C0820-RF-80W-50K-6N39WNU	80	120~277 VAC	7872	ETL, LM79
C0820-RF-100W-40K-N39-W-N-N	100	120~277 VAC	8856	ETL, LM79
C0820-RF-100W-50K-N39-W-N-N	100	120~277 VAC	9840	ETL, LM79
C0820-RF-120W-40K-N39-W-N-N	120	120~277 VAC	10628	ETL, LM79
C0820-RF-120W-50K-N39-W-N-N	120	120~277 VAC	11808	ETL, LM79
C0820-RF-80W-40K-N39-W-N-N	80	120~277 VAC	7085	ETL, LM79
C0820-RF-80W-50K-N39-W-N-N	80	120~277 VAC	7872	ETL, LM79

NOTES: